



Lamorna Grove

Stanmore

£775,000

A four bedroom, double fronted, semi-detached house available with Davidson Frost-Wellings.

On the ground floor the house has a large, modern kitchen with space for a dining table and chairs, as well as access to the rear garden. There is also a double reception room with bay windows at the front and French doors leading to the rear. Upstairs the house has a large master bedroom with space for large wardrobes and a seating area, two further double bedrooms and a fourth single bedroom.

The house is available with a private driveway providing off street parking for multiple cars, as well as a large rear garden extending to nearly 90' with a shed, patio, lawn, trees and flowerbeds.

Harrow Council Tax Band F.

Viewing

Please contact our Davidson Frost-Wellings Office on 020 8954 8806 if you wish to arrange a viewing appointment for this property or require further information.

- Four bedrooms
- Two bathrooms
- Large rear garden
- Private driveway
- Excellent condition
- Semi detached freehold



4



2



1



D

Floor Plan

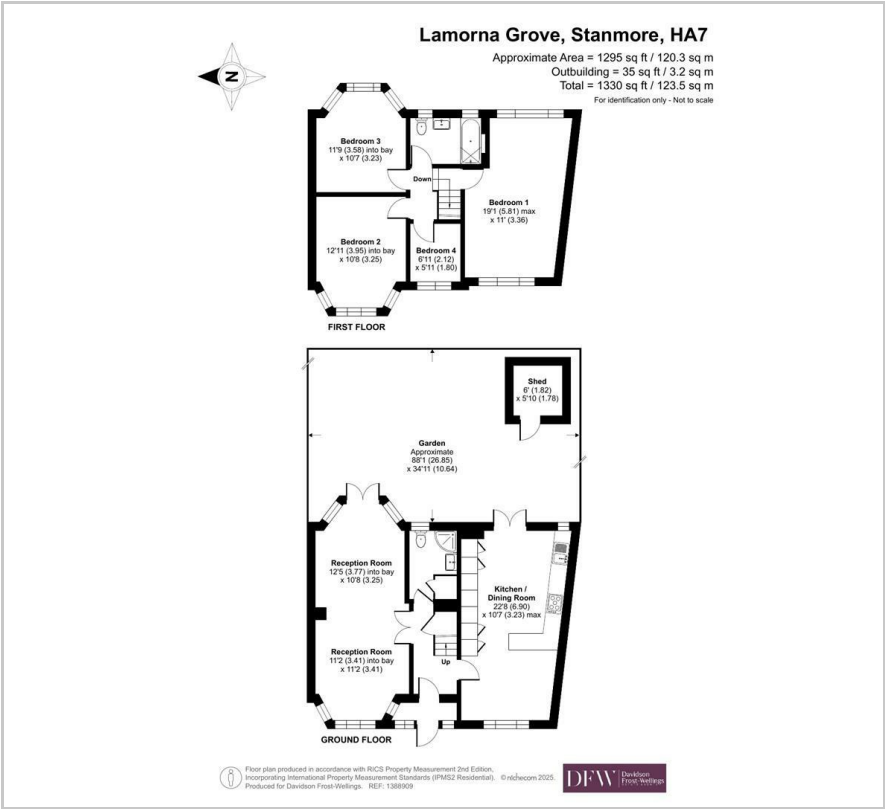

Area Map

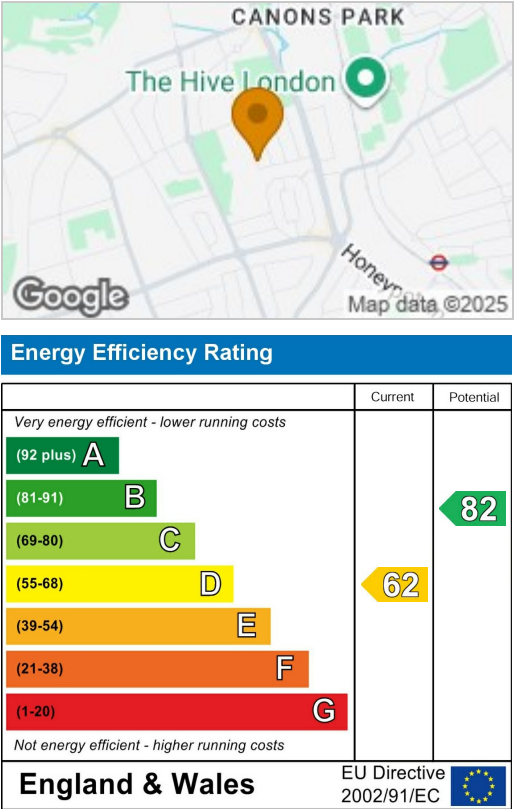

These particulars, whilst believed to be accurate are set out as a general outline only for guidance and do not constitute any part of an offer or contract. Intending purchasers should not rely on them as statements of representation of fact, but must satisfy themselves by inspection or otherwise as to their accuracy. No person in this firms employment has the authority to make or give any representation or warranty in respect of the property.